

FORTY3 VASO TERRA FO001.BI

GLOBO

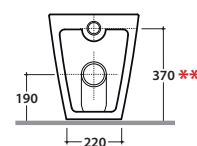
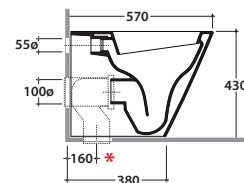
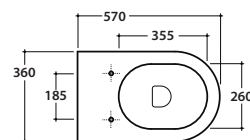

Cod. FO001.BI

Vaso a terra con carico e scarico acqua regolabile MULTI. Scarico parete trasformabile a pavimento tramite curva tecnica fornita a richiesta. Installazione filo parete. Scarico 4,5 / 3 Lt. Completo di FISSAGGIQGHOST®. Peso 26 kg

Floor mounted WC with adjustable water inlet/outlet MULTI. Wall drain turning into floor drain by means of the PVC pipe supplied on demand. Back to wall installation. Drain 4,5 / 3 Lt. FISSAGGIQGHOST® fixing kit included. Weight 26 kg.



Cod. FO019BI

Coprivaso in termoindurente. Peso 3 kg.

Thermo-setting seat-cover. Weight 3 kg.

Cod. FO020BI

Coprivaso in termoindurente chiusura rallentata. Peso 3 kg.

Thermo-setting seat-cover with soft-closing system. Weight 3 kg.

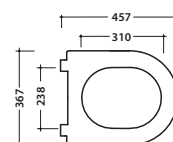
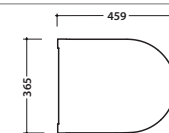

Cod. VA077*

Raccordo per scarico a pavimento regolabile da 6 a 12 cm ø 10.

Elbow pipe for floor drain. Adjustable 6/12 cm ø 10.



Cod. VA079*

Curva tecnica per lo scarico a pavimento regolabile da 13 a 16 cm ø 11.

Elbow pipe for floor drain. Adjustable 13/16 cm ø 11.



Cod. VA078*

Raccordo per scarico a pavimento regolabile da 17 a 21 cm ø 10.

Elbow pipe for floor drain. Adjustable 17/21 cm ø 10.



Cod. VA076

Raccordo per scarico a parete cm. 35

Pipe for wall drain 35cm.



Cod. VA086**

Raccordo eccentrico per entrata acqua h 38,5 cm o h 35,5 cm ø 4.

Eccentric pipe for water inlet 38,5/35,5 cm ø 4.



Cod. VA132

Riduttore flusso di scarico.

Flow reductor.

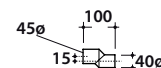
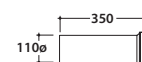
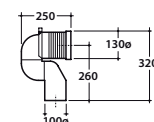
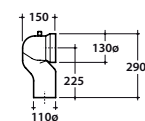
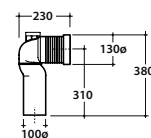

FORTY3 BIDET TERRA FO009.BI

GLOBO

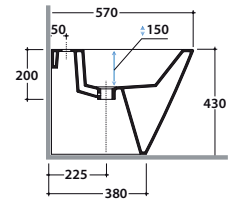
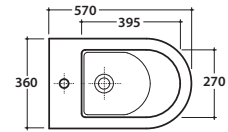

Cod. **FO009.BI**

Bidet a terra monoforo. Carico scarico acqua regolabile MULTI. Installazione filo parete. Completo di FISSAGGIOGHOST®. Peso 25 kg

Floor mounted bidet one hole. Adjustable water inlet / outlet MULTI. Back to wall installation. FISSAGGIOGHOST® fixing kit included. Weight 25 kg.

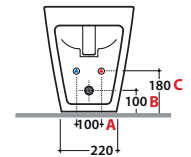

A - da 50 a 160 **B** - da 85 a 130 **C** - da 170 a 220